

Artful *Interior* Accents ... p. 18

hanley▲wood

# AMERICAN DREAM HOMES

AUGUST/SEPTEMBER 2005

THE NATION'S PREMIER HOME MAGAZINE

Go Inside  
**Gorgeous**  
Homes

*From Across the Country!*

Special  
Feature:  
**Luxury**  
Product  
Guide

**Our Top Choices**

For Your Kitchen & Bath

The curving staircase and colorful chandelier skillfully blend the traditional and modern in the foyer.



SKYWAY  
Design by © Skycastle Homes, LLC

# HOUSE BLEND

*A mix of styles produces a truly unique—and spectacular—home*

**U**nder the gently sloping rooflines of this five-bedroom design, you'll find a luxurious blend of Prairie, Craftsman, and Contemporary architectural styles—along with every new-home amenity you could hope for. The wood, stone, and stucco of the front porch lead to a double-door entry and a two-story foyer. Formal living and dining rooms to the left and right give way to the kitchen at the center of the main level. The kitchen, breakfast area, and family room encircle a three-sided fireplace and share a clean, modern design featuring built-in woodworking and French doors leading to a covered porch. The first-floor master suite features a sitting area and a huge walk-in closet with intelligent access to the laundry room. The skylit master bath is a relaxing getaway.



TIM MURPHY/FOTOIMAGERY.COM, COURTESY OF SCOTT RODWIN



(left) The family room is partially open to the breakfast area, with only a three-way fireplace between the two spaces. (below) Dual vanities in the master bath offer the perfect mix: style and convenience.





(opposite) A walk-in shower with a rainwater showerhead highlights the master suite.  
(above) The island kitchen includes two sinks and plenty of counter space.

(this page) The open design connects the foyer to the dining room and living room. (opposite) The family room is a bit more casual, with high ceilings and a pair of skylights.



**PLAN HPR1400008**

STYLE: PRAIRIE  
 FIRST FLOOR: 2,554 SQ. FT.  
 SECOND FLOOR: 1,742 SQ. FT.  
 TOTAL: 4,296 SQ. FT.  
 BEDROOMS: 4  
 BATHROOMS: 3½  
 WIDTH: 97' - 8"  
 DEPTH: 61' - 2"  
 FOUNDATION: UNFINISHED BASEMENT

CALL TOLL FREE 1-866-284-2711

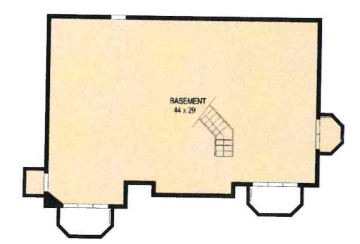
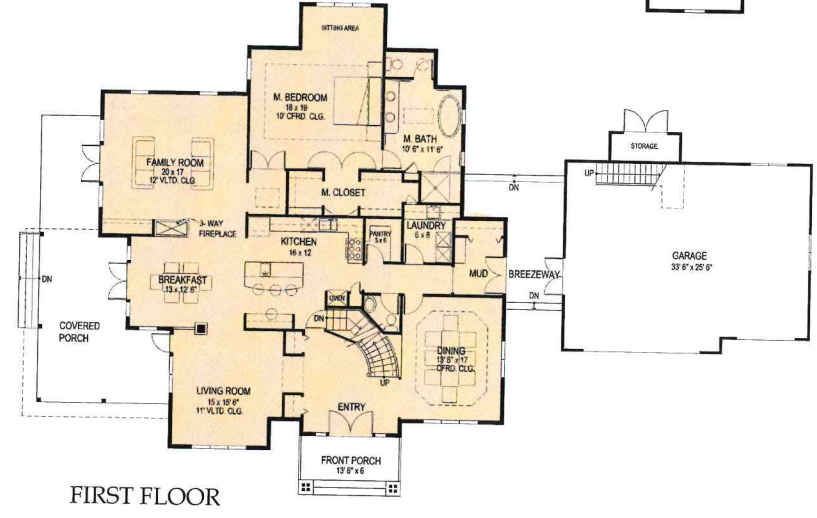

FOR MORE DETAILED INFORMATION, PLEASE CHECK THE FLOOR PLANS CAREFULLY.