

PREMIER ISSUE: BEST NEW PLANS FOR 2007!

House Plans Sampler

BETTER DESIGNERS, BETTER PLANS

SPECIAL!
GET YOUR
HOUSE PLAN
FREE!
(SEE PAGE 253)



365

FANTASTIC HOMES

PLANS YOU WON'T SEE ANYWHERE ELSE

- NEW DESIGN TRENDS
- HOME STYLES FOR ALL TASTES

\$4.99 U.S. • \$6.99 CAN



hanley wood



PLAN NUMBER **HPH1800264**

First Floor: 2,574 sq. ft.
 Second Floor: 880 sq. ft.
 Total: 3,454 sq. ft.
 Bedrooms: 4
 Bathrooms: 3½
 Width: 97' - 8"
 Depth: 61' - 2"
 Foundation: Unfinished Basement

▶ www.eplans.com

This contemporary Craftsman masterpiece offers all the amenities of modern living. Stone, stucco, and exposed wood columns create a sense of solid quality on the exterior, matched by cherry woodwork, granite counters, wrought-iron railings, and other custom touches inside. The gourmet kitchen, with information station and bar counter, is the center of the house. The open floor plan, high windows, and vaulted ceilings create a spacious sunny feeling. The living room and breakfast area both open with French doors onto a generous covered porch. The family room features a three-sided fireplace, built-in entertainment shelves, and a huge wall of windows. The ground floor master suite offers the ultimate in luxury and convenience; note the wall-in closet's pass-through to the laundry room. Two bedrooms upstairs share a compartmented bath, and a third bedroom with private bath and balcony would make excellent quarters for guests or a teenager.

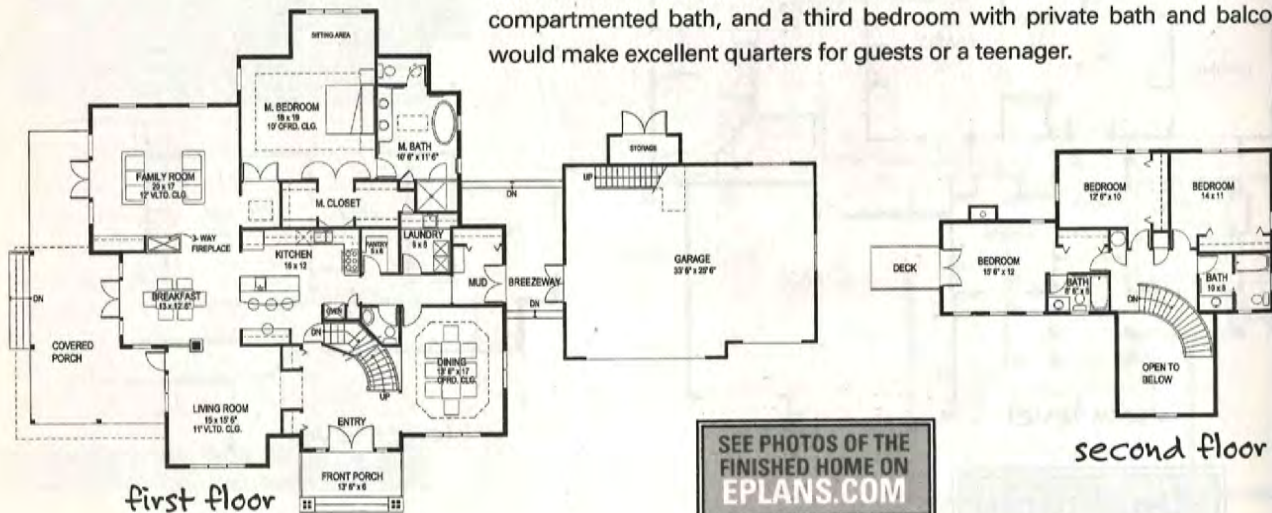

1-SET	5-SET	8-SET	REPRO	CAD
N/A	N/A	N/A	\$1,382	N/A

SEE PHOTOS OF THE FINISHED HOME ON EPLANS.COM

Helpful Hint!
 Want an upgrade? Exchange your first purchase for a credit on a higher-priced plan within 90 days of ordering.